

REVISIONS	BY

William Edward Summers
 Sole Copyright 2020, William Edward Summers
 for: easybuildingplans.com
easybuildingplans@gmail.com, 1 888 655 7284

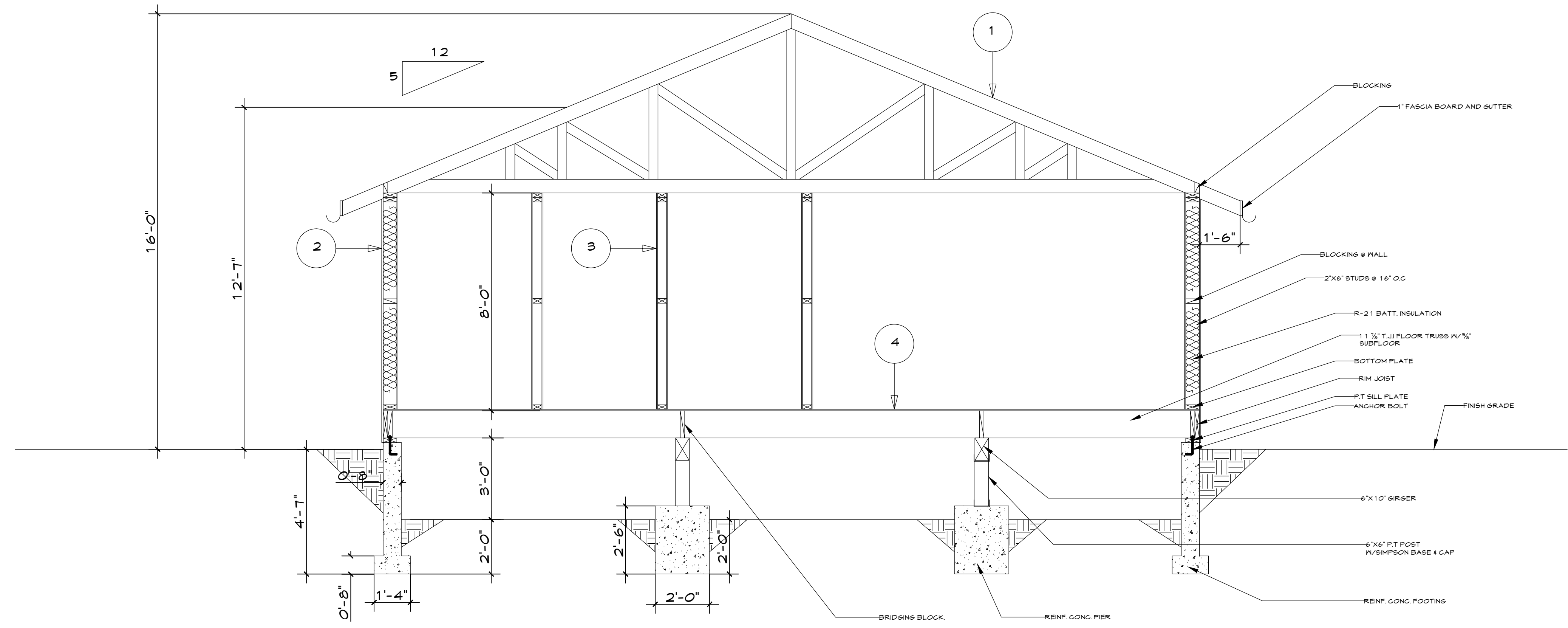

- 1 ROOF ASSEMBLY**
 30YR COMPOSITE SHINGLES
 2 LAYERS OF GRADE D PAPER
 5/8" PLYWOOD DECKING
 PRE-ENGINEERED, PRE-MANUFACTURED TRUSSES, INSTALL PER MANUFACTURER'S SPECS
 R-4.1 INSULATION
 1/2 GNB INTERIOR FINISH

- 2 EXTERIOR WALL ASSEMBLY**
 T-1-1 SIDING
 26ga CORROSION RESISTANT WEEP SCREED
 2 LAYERS OF GRADE D PAPER
 5/8" PLYWOOD SHEATHING
 R-2.1 INSULATION
 2"X6" D.F. #1 STUDS @ 16" o/c
 1/2" GYPSUM WALL BOARD

- 3 INTERIOR WALL ASSEMBLY**
 3/8" GYPSUM WALL BOARD
 2"X4" D.F. #2 STUDS @ 16" o/c
 3/8" GYPSUM WALL BOARD

- 4 WOOD FLOOR ASSEMBLY**
 3/8" PLYWOOD SUBFLOOR
 1 1/8" TJI FLOOR JOIST @ 24" o/c
 6"X10" GIRDER @ MIN. 10'-0" o/c
 6"X6" P.T. POST
 2'X2'X2'-6" REINFORCED CONCRETE POST BASE

SHEET TITLE
 SECTIONS

PROJECT
 PORT GAMBLE SKULLAM HOUSING
 AUTHORITY
 32000 LITTLE BOSTON ROAD NE
 KINGSTON, WA 98346

Date 08/12/2020

Scale 3/8"=1'-0"

Drawn

Job

Sheets

A6